

- Built-in
- Circular
- Stainless steel
- Brushed stainless steel natural finish



Stainless steel external louvres type BLR-E-R

Stainless steel louvres with insectscreen and louvre

Brand

- Cairox

Application

- For air intake or exhaust in ventilation systems

Material

- Stainless steel

Colour

- Brushed stainless steel natural finish

Composition

- Housing and enclined blades made of stainless steel
- Insectscreen fitted behind the louvre
- Weather resistant blades under a 45° angle
- With duct connection flange
- Mounting screws and drip nose included

Mounting

- Fitted into round ducts or round wall openings

Text for tender

- The stainless steel air louvres shall be of the circular type for built-in mounting.
- Brushed stainless steel natural finish with insectscreen and enclined blades
- ATC type **BLR-E-R**

Order example

- **BLR-E-R, 125**

Explanation

BLR-E-R = Type grill

125 = Connection diameter

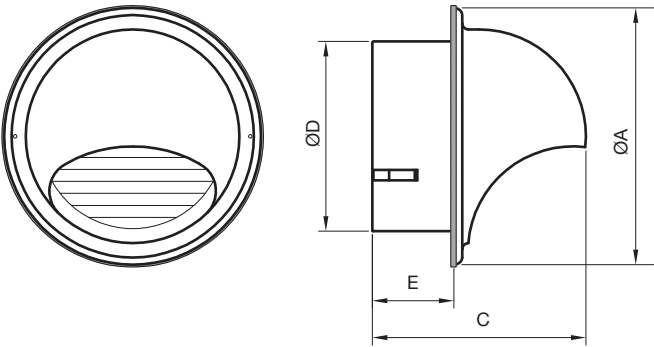

Dimensions				
	ØD [mm]	ØA [mm]	E [mm]	C [mm]
BLR-E-R 100	95	150	42	125
BLR-E-R 125	120	190	48	145
BLR-E-R 150	145	210	55	165
BLR-E-R 160	155	210	55	165
BLR-E-R 180	178	270	60	205
BLR-E-R 200	198	270	60	205

Quick selection							
Q	Ø	100	125	150	160	180	200
30	Ps	7	4				
60		25	15	6	5		
80		46	30	14	11		
110			50	23	20	7	8
130			68	30	29	16	14
190				65	63	26	24
220						32	30
340						70	69

Symbols and specifications

- Q = Air volume in m³/h
- Ps = Static pressure loss in Pa
- Ø = Connection diameter in mm