



## Ring axial fans type RING

Plate mounted axial fans with IEC motor

The range consists of 9 sizes with impeller diameter from 250 up to 700 mm

### Application

- **PLATE-M** fans are designed for installations requiring large capacities with low pressures, in applications for wall or panel fixing f.e. ventilation of commercial and industrial buildings, car parks, stock farms, cooling of electric and refrigerating equipments, etc.

### Construction

- Supporting frame with wide shaped inlet in corrosion proof material or protected against the atmospheric agents
- Motor support and safety grid, in steel rod manufactured in accordance with UNI EN 294
- Execution 5 (impeller directly coupled to motor shaft)
- Conveyed air: clean, not abrasive
- Temperature of conveyed air: -20°C / +50°C
- Air flow from motor to impeller

### Fan/Impeller

- Impeller with high efficiency airfoil blades in plastic material and hub in die cast aluminum alloy. Variable pitch angle install position. Balancing according to UNI ISO 1940

### Motor

- Asynchronous electric motor three or single phase, protection IP 55, class F insulated, output EFF2, service S1, form B5, construction according to IEC / EEC (UNEL-MEC) standards
- Voltage: Three-phase version (T) 400V-3Ph  
Single-phase version (M) 230V-1Ph
- Frequency: 50Hz

**Features and benefits**

- **PLATE-M** fans are characterized by versatility and competitive prices, consequence of accurate design and material choices: impeller is composed of a sturdy hub in die-cast aluminum alloy and blades moulded in different materials suitable for heavy-duty applications. Motor is manufactured according to IEC standards, guarantying reliability and a long term economic recovery of the fan by replacing or repairing the motor itself

**Options**

- Version with die-cast aluminum blades
- Explosion proof version (PLATE- Atex)
- Version with air flow from impeller to motor

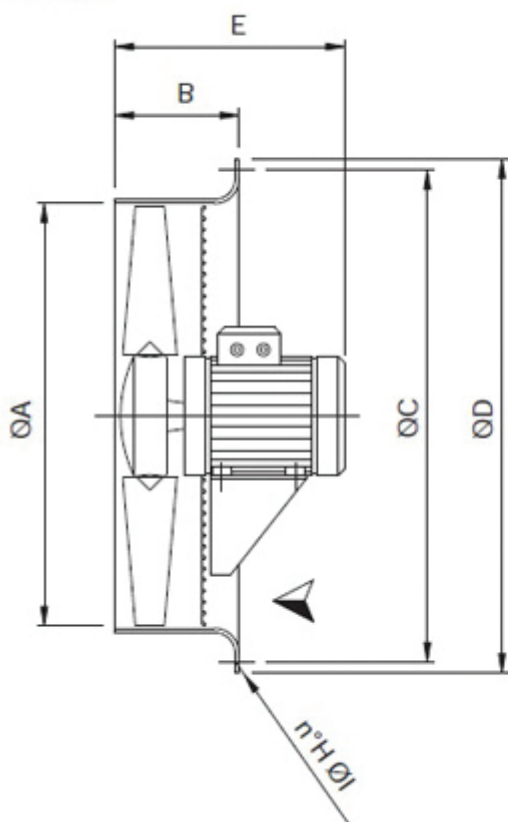
**RING sr**

**RING dr**
